

INSTRUCTION MANUAL

Aldon® Easy-Slide® Box Car Door Opener 4020-13



Aldon Company, Inc. | 3410 Sunset Avenue | Waukegan, Illinois 60087

PH. 847.623.8800 | FX. 847.623.6139
www.aldonco.com | e-rail@aldonco.com

USER INSTRUCTIONS

1. **Fits Standard Fork Blades: Width 5", Thickness 2", Length 48".** (Custom sizes are available.) Center fork blades together and lock one blade, then adjust second fork blade to fit fork tube. Do not force EASY-SLIDE® fork tubes onto wider blades.
2. Use chain provided to secure EASY-SLIDE® frame to forklift mast. Take up slack and hook chain securely.
3. Do not use EASY-SLIDE® where gap between dock edge and side of car exceeds 60-inches.
4. Keep forklift at a safe distance from edge of dock at all times.
5. Unlock car door before using EASY-SLIDE®. Always release plug doors so doors can travel to right or left.
6. Attach pincer hook to pull-tab on car door. Use caution when hooking to other access points on door.
7. Be aware which way the door is to open or close before starting to pull.
8. Never ram the car door with pivot arm. Always pull the door using the hook.
9. Direction of force applied by pivot arm must parallel to car door travel.
10. **NEVER PULL** perpendicular to car door or at an angle greater than 45 degrees, to avoid pulling door off its tracks.
11. Stop pulling when door is fully open or closed. Do not run door off the end of its track.
12. Forklift operator must keep door in sight at all times when using EASY-SLIDE®.
13. If door will not open using reasonable force, investigate reason.

ALDON® EASY-SLIDE® Door Opener

To Open the Door...

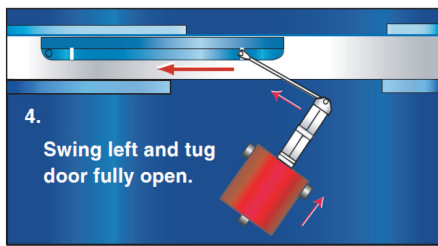
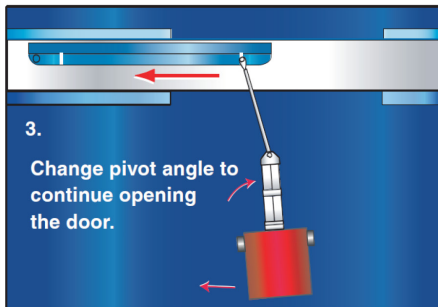
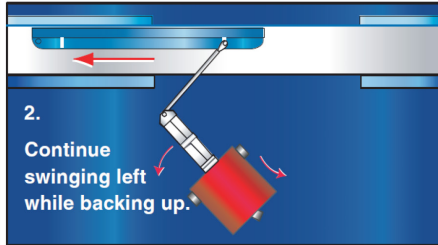
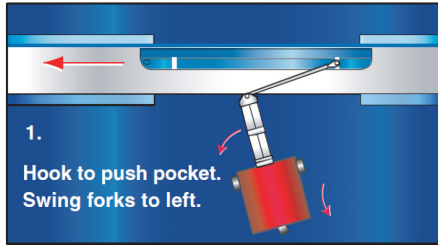

To Close the Door...

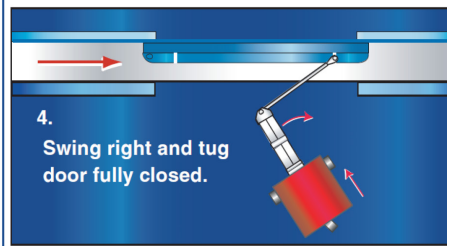
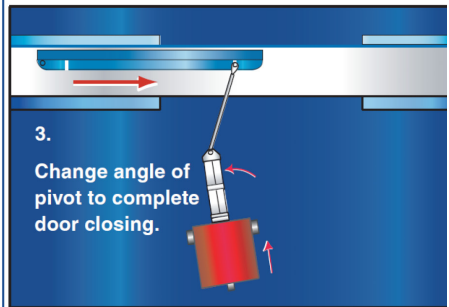
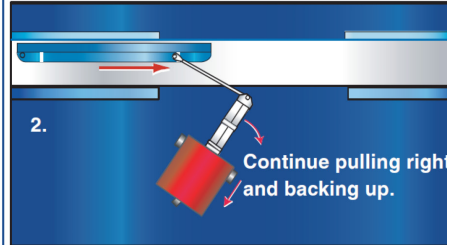
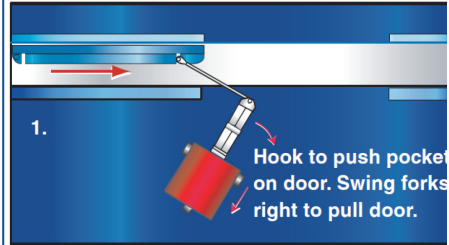

Have A Question?

"ASK ALDON"
AskAldon@aldonco.com

WARNING TO OPERATOR

1. Always use pincer hook to pull car door. Do not use the end of the pivot arm as a ram, or car door will be damaged.
2. When opening or closing car doors, always keep pivot arm level with car door pull tab. If pivot arm is used above or below pull-tab height, EASY-SLIDE® frame and hook may sustain damage.
3. Stop moving backwards when pivot arm straightens out and is in line with EASY-SLIDE® frame. Pulling backwards with pivot arm perpendicular to car door will damage EASY-SLIDE® and may cause door to come off its track.

RECOMMENDED PRODUCTS



Railroad Dock Board 4128-01

Request sizing form for pricing.

- Portable steel bridge from box car to dock.
- Lifting loops on dock board allow easy placement by forklift. Curbs at sides of dock board guide forklift driver.
- Straight-cut or flared approach aprons.
- Locking rings on each side wedge dock board against dock.
- Capacities: 15,000 lbs., 22,000 lbs., and 42,000 lbs.



Aldon Company, Inc. | 3410 Sunset Avenue | Waukegan, Illinois 60087

PH. 847.623.8800 | FX. 847.623.6139
www.aldonco.com | e-rail@aldonco.com

Revised 08/2021